

### Dati tecnici

### Technical data

### Technische Daten

Dati tecnici	Technical data	Technische Daten	R404A
Refrigerante	Refrigerant	Kältemittel	R404A
Capacità volumetrica 50 Hz	Displacement 50 Hz	Hubvolumen 50 Hz	m <sup>3</sup> /h 106.16
Potenza nominale	Nominal power	Elektromotor	kW (HP) 26.0 (35)
Numero di cilindri	Number of cylinders	Zylinderummer	6
Alesaggio	Bore	Bohrung	mm 68
Corsa	Stroke	Hub	mm 56
Lubrificante	Lubricant	Ölsorte	P.O.E.
Carica di lubrificante	Lubricant charge	Ölmenge	l 4.5
Peso netto	Net weight	Nettogewicht	kg 223
Peso lordo	Gross weight	Bruttogewicht	kg 245
Volume imballo	Packing volume	Verpackungsvolumen	dm <sup>3</sup> 355

### Dimensioni di ingombro

### Dimensional drawing

### Mass Zeichnung

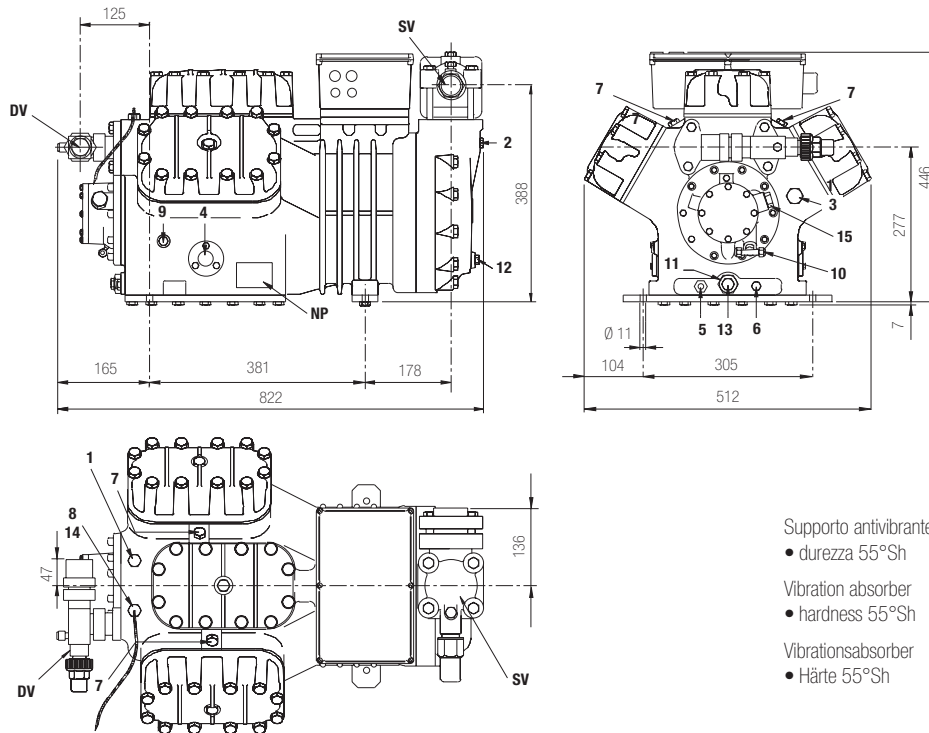

Supporto antivibrante  
• durezza 55°Sh  
Vibration absorber  
• hardness 55°Sh  
Vibrationsabsorber  
• Härte 55°Sh

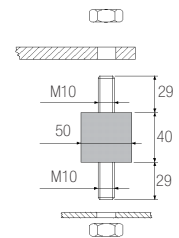

1	attacco di alta pressione	high pressure connection	Hochdruckanschluss	1/8" NPT
2	attacco di bassa pressione	low pressure connection	Niederdruckanschluss	1/4" NPT
3	tappo di carico olio	oil charge plug	Ölfüllung Stopfen	3/8" GAS
4	spia livello olio	oil level sight glass	Ölschauglas	
5	sede resistenza carter	crankcase heater seat	Pos. für Ölsumpfheizung	
6	tappo scarico olio	oil drain plug	Ölablass Stopfen	1/4" GAS
7	attacco per valvola iniezione di liquido	liquid injection valve connection	Flüssigkeitseinspritzungsanschluss	1/8" NPT
8	attacco per sensore iniezione di liquido	liquid injection sensor connection	Sensoranschluss	1/8" NPT
9	attacco pressostato differenziale olio (b.p.)	oil pressure switch connection (l.p.)	Öldruckschalter Niederdruckanschluss	1/4" NPT
10	attacco pressostato differenziale olio (a.p.)	oil pressure switch connection (h.p.)	Öldruckschalter Hochdruckanschluss	1/4" SAE
11	filtro olio	oil filter	Ölfilter	
12	tappo ritorno olio	oil return plug	Ölrückführung Stopfen	1/8" NPT
13	tappo magnetico	magnetic plug	Magnetstopfen	
14	attacco sensore massima temp.compress.	max. discharge temperature sensor connection	Druckgasfühleranschluss	1/8" NPT
15	attacco pressostato olio elettronico	electronic oil pressure switch connection	Elektronische Öldruckschalteranschluss	M8x22 ISO4017
DV	rubinetto di compressione	discharge valve	Druckventil	1 3/8" 35.0 mm
NP	targhetta	name plate	Verdichtertypschild	
SV	rubinetto di aspirazione	suction valve	Saugventil	2 1/8" 54.0 mm

Condensazione Condensing temperature Verflüssigungs- temperatur °C	<b>R404A</b>										
	Temperatura di evaporazione °C			Evaporating temperature °C				Verdampfungstemperatur °C			
	7.5	5	0	-5	-10	-15	-20	-25	-30	-35	-40
<b>Capacità frigorifera W</b>			<b>Refrigerating capacity W</b>				<b>Kälteleistungsdaten W</b>				
20			121220	100570	82500	66840	53430	42100	32670	24970	18830
25	146780	134760	112780	93430	76530	61920	49420	38870	30080	22900	17150
30	136180	124930	104390	86350	70620	57060	45470	35700	27570	20900	15540
35	125630	115150	96050	79320	64780	52260	41590	32600	25120	18980	14010
40	115140	105420	87770	72350	58990	47530	37780	29580	22760	17150	12570
45	104710	95770	79560	65460	53290	42880	34050	26650	20490	15410	11230
50	94350	86180	71430	58650	47670	38310	30420	23810	18320		
55	84080	76680	63390	51930	42140	33850	26880				
<b>Potenza assorbita W</b>			<b>Input power W</b>				<b>Leistungsaufnahme W</b>				
20			16646	16755	16450	15795	14855	13696	12380	10974	9542
25	18524	18784	18935	18646	17983	17009	15790	14390	12875	11307	9753
30	21340	21371	21095	20418	19407	18124	16635	15005	13299	11580	9914
35	24017	23826	23132	22077	20727	19145	17397	15547	13660	11800	10032
40	26564	26154	25053	23630	21951	20080	18082	16022	13964	11972	10112
45	28958	29361	26863	25082	23084	20934	18696	16436	14217	12104	10162
50	31287	30455	28569	26439	24133	21714	19246	16795	14425		
55	33477	32441	30177	27709	25104	22425	19738				
<b>C.O.P.</b>											
20			7.282	6.002	5.015	4.232	3.597	3.074	2.639	2.275	1.973
25	7.924	7.174	5.956	5.011	4.256	3.641	3.130	2.701	2.337	2.025	1.758
30	6.382	5.845	4.948	4.229	3.639	3.148	2.733	2.379	2.073	1.805	1.567
35	5.231	4.833	4.152	3.593	3.125	2.729	2.390	2.097	1.839	1.609	1.397
40	4.334	4.031	3.503	3.062	2.688	2.367	2.089	1.846	1.630	1.432	1.243
45	3.612	3.377	2.962	2.610	2.308	2.048	1.821	1.621	1.441	1.273	1.105
50	3.016	2.830	2.500	2.218	1.975	1.765	1.580	1.418	1.270		
55	2.511	2.364	2.101	1.874	1.679	1.509	1.362				

Z 35 106 Y - R404A - 20061228 • FRASCOLD SPA - Italy

con raffreddamento delle teste

with head cooling

mit Zylinderkopfkühlung

Prestazioni calcolate alle seguenti condizioni:  
 - alimentazione 400/3/50  
 - senza sottoraffreddamento del liquido  
 - temperatura del gas aspirato 20°C

Performance are based on the following conditions:  
 - supply 400/3/50  
 - without liquid subcooling  
 - suction gas temperature 20°C

Die gezeigten Leistungsdaten basieren auf den folgenden Bedingungen:  
 - Netz 400/3/50  
 - ohne Flüssigkeitsunterkühlung  
 - Sauggastemperatur 20°C



I dati delle prestazioni dei compressori sono certificati secondo le norme ASERCOM. I compressori certificati sono elencati nel sito web ASERCOM -www.ASERCOM.org



Performance data of the compressor are certified according to the ASERCOM standards. All certified compressors are listed on the ASERCOM web site - www.ASERCOM.org



Leistungsdaten von Verdichtern sind nach dem ASERCOM Standard gekennzeichnet. Die ASERCOM gekennzeichneten Verdichtern sind in der Web-Site des ASERCOM gelistet - www.ASERCOM.org